

South T-Hangars – 47-56

Southwest Facing Side

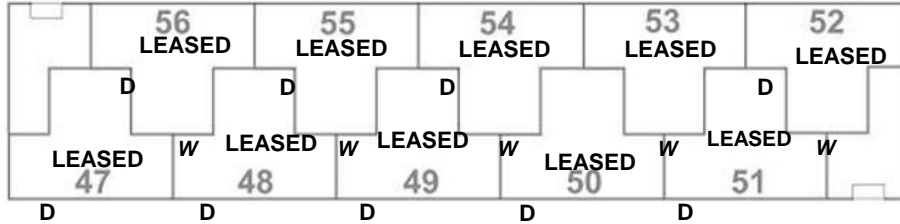

East T-Hangars – 1-46

North Facing Side

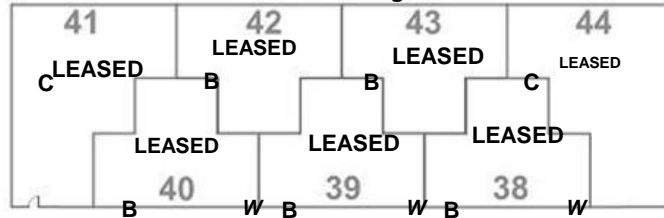

North Facing Side

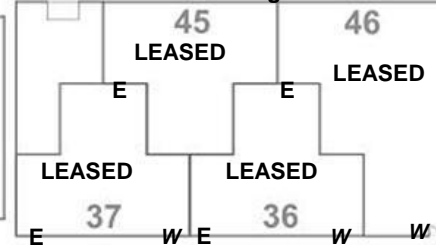

North Facing Side

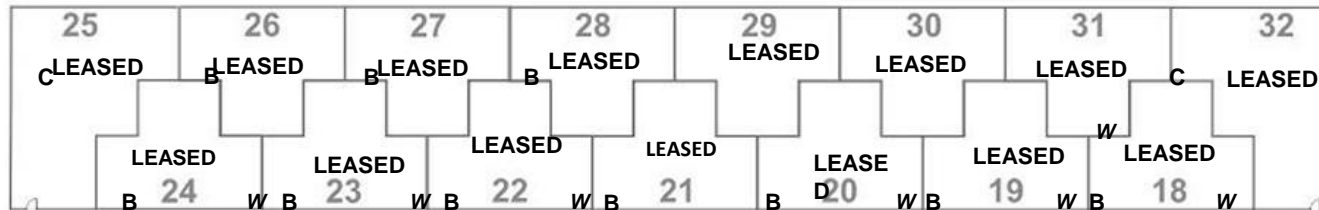

North Facing Side

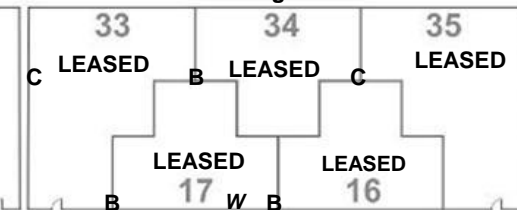

North Facing Side



North Facing Side

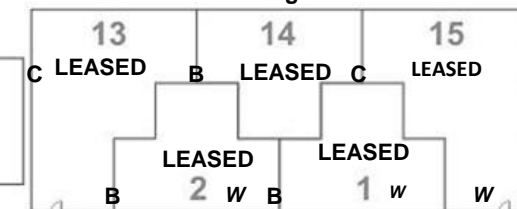

T-Hangar Sizes and Rates

(New rates as of 7/5/2022 - Res. No. 439)

A. \$146.00 a month (No longer renting)

Slide Door Width – 39' 9"
Depth – 31' 4"
Tail Width – 12' 5"
*Hangar #3 & #8 offers extra storage space

B. \$182.00 a month (24 available - #'s 1,2,14,16,17-24,26-31,34,38-

40,42,43)
Electric Bi-Fold Door Width – 41' 6"
Depth – 32'
Tail Width – 20' 6"
Height Clearance – 11' 11"

C. \$203.00 a month (8 available - #'s 13,15,25,32,33,35,41,44)

End T-Hangars
Dimensions – Same As Above
*Each Hangar offers extra storage space

D. \$233.00 a month (10 available - #'s 47-56)

Electric Bi-Fold Door Width – 42'
Depth – 33'
Height Clearance – 12'

E. \$242.00 a month (4 available - #'s 36,37,45,46)

Electric Bi-Fold Door Width – 43' 6"
Depth – 38'
Tail Width – 21' 7"
Height Clearance – 13' 11"
*Hangar #46 offers extra storage space

W. Check waiting list prior to re-renting